

STRONG • SMOOTH • RELIABLE



MWL SERIES ●



MWH SERIES ●



Mr. Wheel
CASTOR & TROLLEY WHEELS

MWLSP SERIES ●



Explore High Quality
CASTOR WHEELS ▶
for smooth and easy movement

MWFAB SERIES ●



MWL SERIES

Medium duty zinc plated pressed steel castor of double ball race swivel head secured with thick rivet & covered with nylon dust seal. Two sealed ball bearings are used in the wheel in order to give force-less free movement to castor. Pillar & brake type castors are also available suitable for hotel & hospital furniture.



SWIVEL



FIXED



LOCK

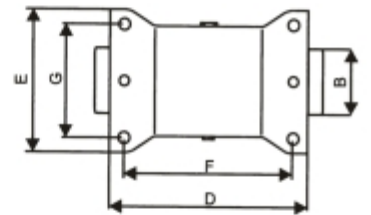
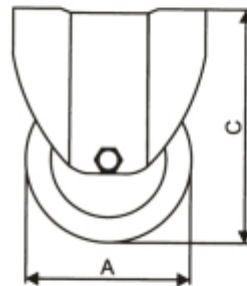
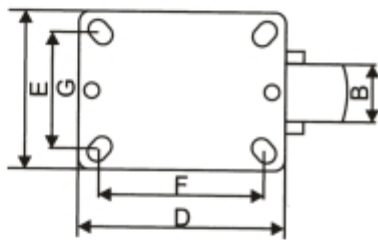
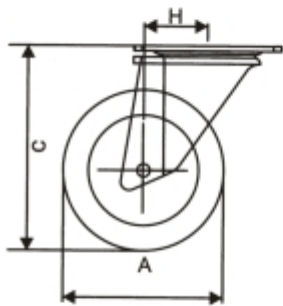

Technical Specifications

Wheel Diameter (A)	Wheel Width (B)	Overall Height (C)	Swivel Plate Size (D X E)	Swivel Hole Center (F X G)	Fixed Plate Size (D X E)	Fixed Hole Center (F X G)	Offset (H)	Plate Thickness	Wheel Block Thickness	Load Capacity
75	25	100	78x60	54x40	-	-	31	2.5	2	30-45
100	25	127	78x60	54x40	-	-	31	2.5	2	40-50
75	32	103	98x73	73x50	96x76	73x50	33	2.5	2.3	50-70
100	32	128	98x73	73x50	96x76	73x50	38	2.5	2.3	50-70
125	32	152	98x73	73x50	96x76	73x50	39	2.5	2.3	60-80
100	38	127	91x91	70x70	112x83	85x55	41	3.2	2.8	80-100
125	38	155	91x91	70x70	112x83	85x55	48	3.2	2.8	80-100
150	38	182	116x91	85x69	112x83	85x55	48	3.2	2.8	90-110
100	50	135	137x105	105x78	137x113	105x78	44	3.5	3	120-150
150	50	190	137x105	105x78	137x113	105x78	47	3.5	3	150-200
200	50	240	137x105	105x78	137x113	105x78	52	3.5	3	180-220

A. All dimensions in mm. B. The load capacity is for smooth surface of a maximum speed of 3 kmph. C. Design & Specification subject to change without prior notice.



MWH SERIES

This is heavy duty forged steel castor. Steel balls are accommodated between two ball races. The top forged swivel base plate is interlocked by these steel balls with the inner ring part of the cup which serves both as thrust and taper bearings. A nylon ring seal is provided for dust protection. Grease nipple is also provided at the cup portion which is used for self lubrication purpose.



SWIVEL



FIXED



LOCK

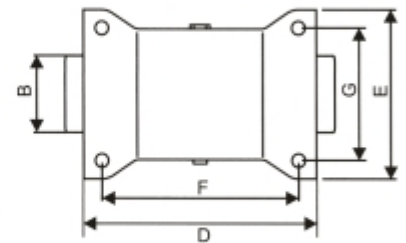
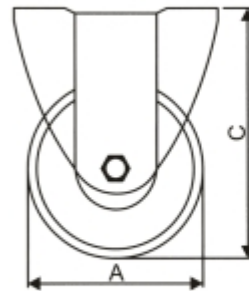
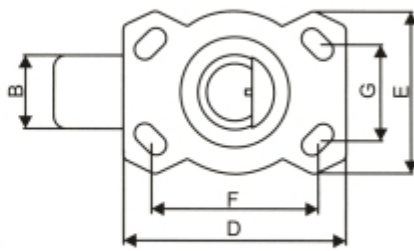
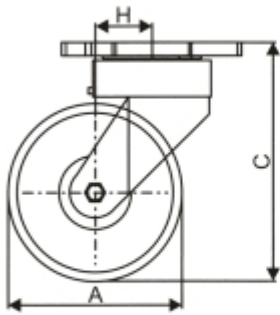

Technical Specifications

Wheel Diameter (A)	Wheel Width (B)	Overall Height (C)	Swivel Plate Size (D X E)	Swivel Hole Center (F X G)	Fixed Plate Size (D X E)	Fixed Hole Center (F X G)	Offset (H)	Plate Thickness	Wheel Block Thickness	Load Capacity
100	50	160	152X110	120X60	150X112	120X60	48	10	6	200-300
150	50	205	152X110	120X60	150X112	120X60	58	10	6	300-400
200	50	254	152X110	120X60	150X112	120X60	72	10	6	400-500

A. All dimensions in mm. B. The load capacity is for smooth surface of a maximum speed of 3 kmph. C. Design & Specification subject to change without prior notice.



MWLSP SERIES

Light duty powder coated pressed steel castor of double ball race swivel head secured with thick thread hex pin & covered with nylon dust seal. Two sealed ball bearings are used in the wheel in order to give force-less free movement to castor. Heavy duty polyurethane spring is provided at the back side which protects the castor from heavy jerk load & thus not causing any damages of components under dynamic conditions.



SWIVEL



FIXED



LOCK

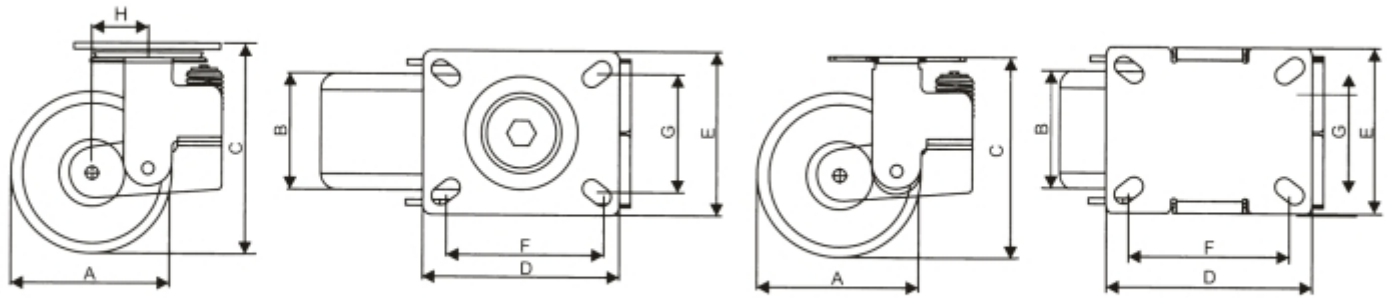

Technical Specifications

Wheel Diameter (A)	Wheel Width (B)	Overall Height (C)	Swivel Plate Size (D X E)	Swivel Hole Center (F X G)	Fixed Plate Size (D X E)	Fixed Hole Center (F X G)	Offset (H)	Plate Thickness	Wheel Block Thickness	Load Capacity
100	50	185	155X110	128x74	160X112	128X74	52	5	5	200-250
150	50	210	155X110	128x74	160X112	128x74	52	5	5	200-400
200	50	260	155X110	128x74	160X112	128x74	78	5	5	250-450

A. All dimensions in mm. B. The load capacity is for smooth surface of a maximum speed of 3 kmph. C. Design & Specification subject to change without prior notice.



MWFAB SERIES

Medium duty zinc plated fabricated castor made from thick plate which consists of double ball race ways at the swivel head secured with rivet. The swivel & wheel lock is simplified under one lever as ON/OFF breaking system for easy operation.



SWIVEL



FIXED



LOCK

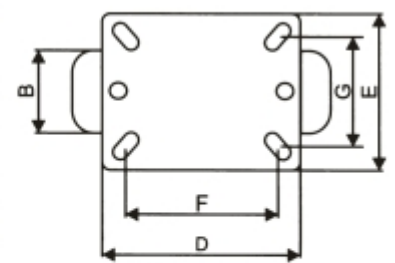
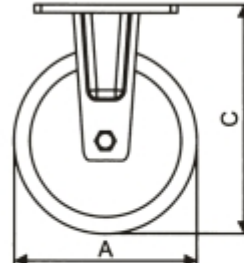
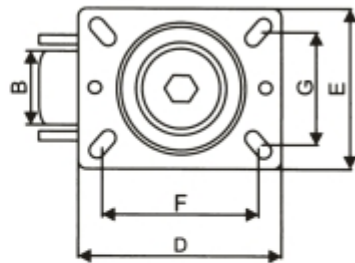
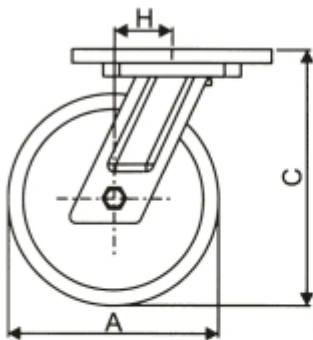

Technical Specifications

Wheel Diameter (A)	Wheel Width (B)	Overall Height (C)	Swivel Plate Size (D X E)	Swivel Hole Center (F X G)	Fixed Plate Size (D X E)	Fixed Hole Center (F X G)	Offset (H)	Plate Thickness	Wheel Block Thickness	Load Capacity
100	50	142	115x100	85x70	115x100	85x70	41	5	5	200-250
125	50	165	115x100	85x70	115x100	85x70	45	5	5	225-275
150	50	190	115x100	85x70	115x100	85x70	48	5	5	250-300
200	50	246	115x100	85x70	115x100	85x70	56	5	5	300-350

A. All dimensions in mm. B. The load capacity is for smooth surface of a maximum speed of 3 kmph. C. Design & Specification subject to change without prior notice.



STRONG • SMOOTH • RELIABLE



WR3



WBCPPU



WCP



WCIR



WBMSTPUR



WCIPUTAA

- | | |
|-----------------|------------------------------|
| WR3 | - Rubber Wheel on Metal Disc |
| WBCPPU | - PU Wheel with PPCP Disc |
| WCP | - White PPCP Wheel |
| WCIR | - Cast Iron Wheel |
| WBMSTPUR | - Black PU on MS Rim |
| WCIPUTAA | - Full PU Molding on CI Core |

Authorised Dealer



Manufactured by :
Bharat Industrial Corporation Private Limited

Mr. Wheel
CASTOR & TROLLEY WHEELS